

# B Vent Roof Flashing Flat Welded

| Part #      | Size | Top Diameter |
|-------------|------|--------------|
| 602-1405 HW | 4"   | 4-1/2"       |
| 602-1410 HW | 5"   | 5-1/2"       |
| 602-1415 HW | 6"   | 6-1/2"       |
| 602-1420 HW | 7"   | 7-1/2"       |
| 602-1425 HW | 8"   | 8-1/2"       |
| 602-1430 HW | 9"   | 9-1/2"       |
| 602-1435 HW | 10"  | 10-1/2"      |
| 602-1436 HW | 11"  | 11-1/2"      |
| 602-1440 HW | 12"  | 12-1/2"      |

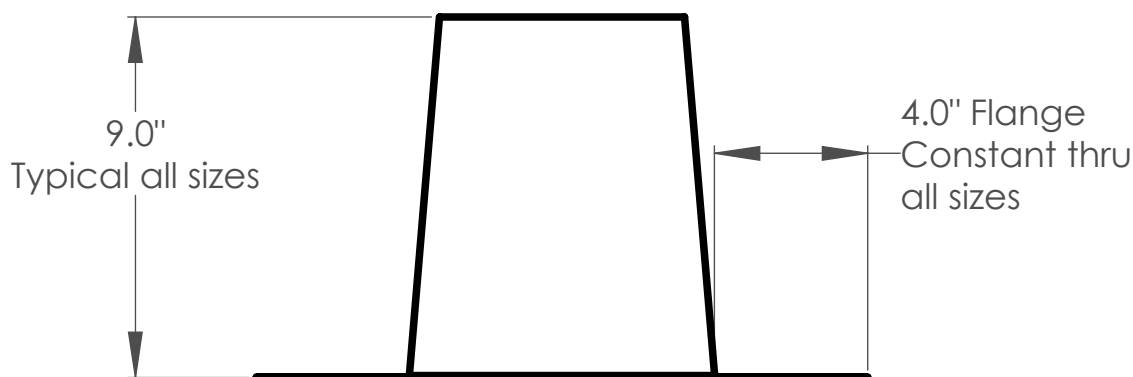
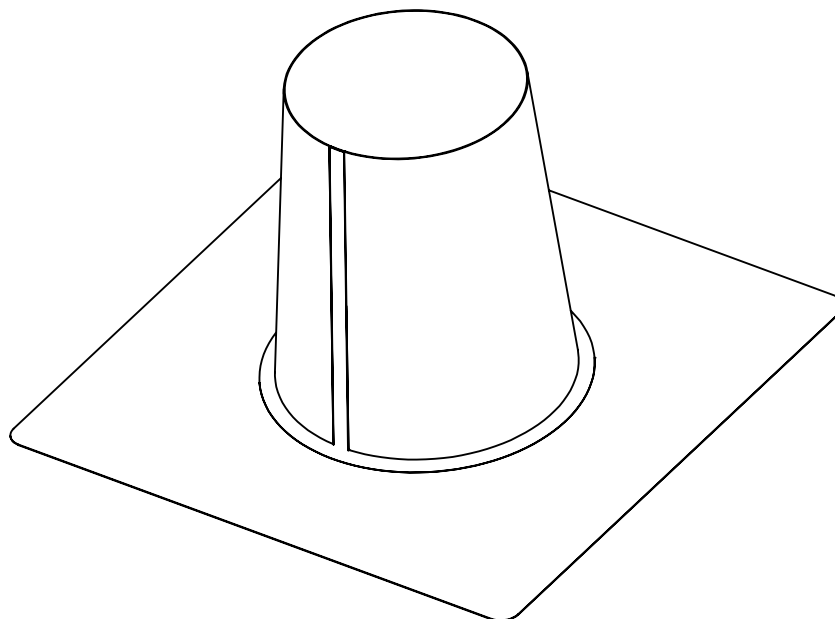

## Features

- Hotweld construction
- Heavy galvanized steel
- Available in TPO Direct Weld

Innovative Ideas Since 1978

**PROPRIETARY AND CONFIDENTIAL**

THE INFORMATION CONTAINED  
IN THIS DRAWING IS THE SOLE  
PROPERTY OF MENZIES METAL  
PRODUCTS.  
ANY REPRODUCTION IN PART OR  
AS A WHOLE WITHOUT THE WRITTEN  
PERMISSION OF MENZIES METAL  
PRODUCTS IS PROHIBITED.

DATE: 02/14/18

DRAWN BY: ZV

COMMENTS:

DO NOT SCALE DRAWING

Part title & J#

**B Vent Roof Flashing Flat Welded**

SIZE

**A**



19370 - 60th Ave., Surrey, BC V3S 3M2  
Ph: 604-530-0712  
Fax: 604-530-8482  
[www.menzies-metal.com](http://www.menzies-metal.com)